

# Maintaining Your PWR Pair

## Daily Care Tips for Your Device



Ensure staying power and protect your investment by regularly maintaining your PWR Pair Piezo Scaling and Air Polishing device. Adhere to the following PWRful tips for **Best In Practice** performance.



### After Each Patient Maintenance Checklist

- Remove PWR Piezo Tip from PWR Piezo LED Handpiece using the Torque Wrench.
- Disconnect the PWR Piezo LED and PWR Air Polishing handpiece from their respective cords. Refer to below illustrations regarding disconnecting PWR Air Polishing Handpiece.



- Unscrew nose cone and remove light guide from PWR Piezo LED Handpiece.

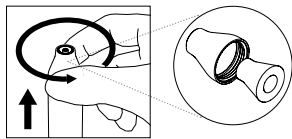

- Clean and Sterilize PWR Air Polishing and Piezo Handpieces, Torque Wrench and PWR Piezo Tip(s) used, all in individual sterilization pouches.

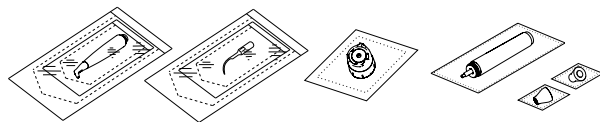

- Clean non-sterilizable parts of the device with a compatible EPA-registered intermediate-level surface disinfectant.



For a full list of instructions, please refer to the **PWR Pair Instructions For Use**.

### End of Day Maintenance Checklist

- Use the Flush function with your PWR Piezo LED Handpiece attached using distilled water.
- Detach 500ml bottle and use the Flush function again to remove all remaining water.
- Use the “Refill” function to release pressure and proceed to remove the powder chambers.

**REMINDER:** Wait until the “Refill” LED stops flashing



- Dispose of remaining powder.  
**WARNING:** May be compromised by moisture
- Clean the powder chamber with compressed air  
**REMINDER:** Be sure to blow compressed air between threads and on the o-ring
- Use the Flush function with your PWR Air Polishing Handpiece attached.
- Ensure that your PWR Pair device is switched off.
- Clean the PWR Piezo device, handpiece cord and footswitch using a clean, dry cloth with a low fiber release, dampened with a detergent solution (pH 6-9).

